

Fire Exit Signs

Fire exit signs are used on doors, emergency or fire escape routes. The Contract Range range of fire exit signs incorporates 75mm letter height to comply with Fire Precautions Act 1971 and include 'symbol only' versions to suit EC Council Directives.

- Designed to comply with EC Council Directive 92/558/EEC and Fire Precautions Act 1971
- Supplied with wood screws or self adhesive pads for alternative fixing method
- All signs available in the following finish and fixing combinations:
Aluminium - screw fixed
Aluminium - self adhesive
Vinyl-self adhesive
Plastic - screw fixed
Plastic - self adhesive

Photoluminescent Signs

The signs shown on this page are also available in photoluminescent material which are energised by exposure to light. When the light source fails, the material emits a highly visible luminescence which lasts for several hours. The natural photoluminescent daylight colour of light green has been officially recognised in BS 5499 and BS 5378 as suitable for use in safety signs.

Sizes

The standard signs are available in the sizes shown. All the signs are available in other sizes to special order.

Please Note

The signs shown on this page are for identification purposes only. They are not shown to scale, please refer to the dimensions shown.



Dimensions .1100mm x 240mm
.2 150mm x 360mm



LG.LA 60 071 - 75mm x 150mm

LG.LA 60 070 - 75mm x 150mm

LG.LA 60 072 - 75mm x 150mm

LG.LA 60 073 - 75mm x 150mm

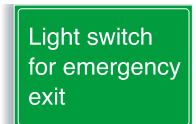
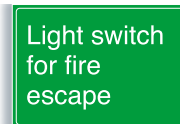

LG.LA 60 055
150mm x 150mm

LG.LA 60 051
225mm x 225mm

LG.LA 60 060 - 100mm x 140mm

LG.LA 60 062 - 100mm x 140mm



LG.LA 60 056 - 150mm x 280mm



LG.LA 60 054 - 140mm x 470mm

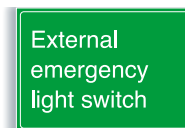

LG.LA 60 063 - 100mm x 140mm



LG.LA 60 052.1 - 65mm x 280mm
LG.LA 60 052.2 - 130mm x 565mm

All dimensions are shown in mm

Finish code is part of each product code - e.g LG.LA600.75.01.153 for SS finish or LG.LA600.75.02.153 for PS finish

CONTRACT RANGE - SIGNS & SYMBOLS

Tactile Symbols

Contract Range tactile signs incorporate a combination of visual identification, Braille, raised symbols and letters to assist visually impaired people to locate facilities within a building.

- High contrast ivory on dark blue signs
- Self adhesive back for easy fixing to most flat surfaces



| Item no. | Symbol | PVC | Unit |
|---------------|-------------|-----|--------|
| LG.LA60 001.1 | male | • | single |
| LG.LA60 001.2 | female | • | single |
| LG.LA60 001.3 | disabled | • | single |
| LG.LA60 001.4 | baby change | • | single |
| LG.LA60 001.7 | telephone | • | single |



Disability Discrimination

The use of tactile signage is a requirement of Part M2 of the Building Regulations 1991 and it recognises the use of tactile signs ensures people with visual impairments are considered under the requirements of the Disability Discrimination Act.

Safety & Security Signs

Safety and security signs are mandatory and require a specific behaviour or action to be taken. By separating the symbol and the wording the signs are designed to comply with EC Council Directive 92/58/EEC.

- Designed to comply with EC Council Directive 92/58/EEC
- All signs white lettering on blue background
- Supplied with wood screws or self adhesive pads for alternative fixing method
- All signs available in the following finish and fixing combinations:
 - Aluminium - screw fixed
 - Aluminium - self adhesive
 - Vinyl - self adhesive
 - Plastic - screw fixed
 - Plastic - self adhesive



Sizes

Signs LG.LA60 030 to LG.LA60 048 are 80mm x 80mm.
Signs LG.LA60 345.2 & LG.LA60 346.2 are 400mm x 300mm.
Signs LG.LA60 345.1 & LG.LA60 346.1 are 200mm x 150mm.

Other sizes available to order along with non-standard signs. Please contact your Laidlaw Gulf Technical Consultant for further details.

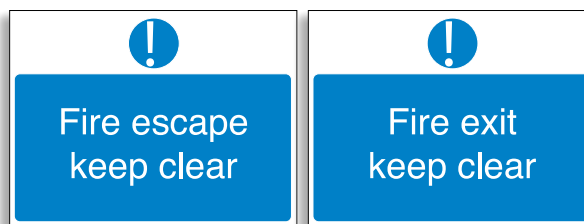

LG.LA60 345.2 - 400mm x 300mm

LG.LA60 346.2 - 400mm x 300mm



LG.LA60 345.1 - 200mm x 150mm



LG.LA60 346.1 - 200mm x 150mm

Please Note

The signs shown on this page are for identification purposes only. They are not shown to scale, please refer to the dimensions shown.